



VANCOUVER ISLAND  
CONFERENCE CENTRE

# Location. Location. Inspiration.

One of the best things about the Vancouver Island Conference Centre is the location. With access to Nanaimo's airport and seaplane and ferry terminals - Nanaimo, B.C. is one of the most accessible prime convention and event venues in the Pacific Northwest.



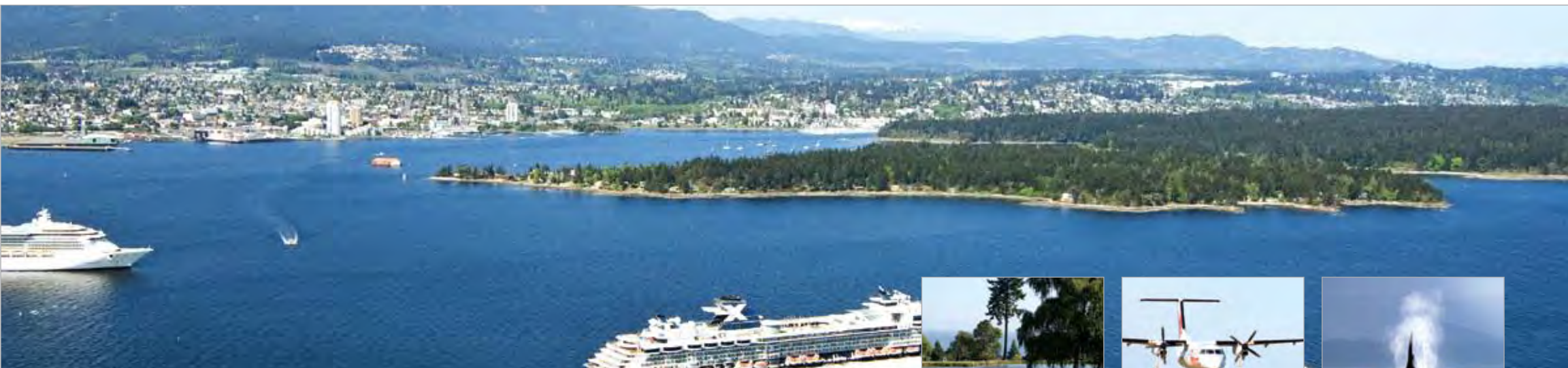

VANCOUVER ISLAND  
CONFERENCE CENTRE

# Invite your world



# Come and see ours



Inspire your colleagues with what's outside the conference room window. Give them the wonder of the west coast and the charm of a walkable downtown. The new Vancouver Island Conference Centre in Nanaimo sits at the heart of it all.

Canada's newest full-service conference centre with ultra-smart technology is just steps away from the scenic Nanaimo harbour and seaside walkway. Downtown's quaint shops, hotels, patio cafés and art galleries add to the urban character.

From Nanaimo you can easily explore Vancouver Island, consistently rated 'Top North American Island' by readers of Condé Nast Traveler magazine. Surf at Long Beach in Pacific Rim National Park, or experience some of B.C.'s best wines on a vineyard tour.



Canada's  
newest  
full-service  
conference  
centre with  
ultra-smart  
technology  
is just steps  
away from the  
scenic Nanaimo  
Harbour.



# Smart design



At first glance you will notice the more eye-catching elements of the design. Exquisite hand-blown glass pendant lighting is a striking focal point in both entrance lobbies, and the organic stone mural created by a local artist follows the gentle curve of the wall in undulating swirls. The decorative accents and finishes are anything but standard issue and evoke the latest in contemporary design ideals.

A closer look reveals the strategic savvy behind the design. An open-concept floor plan accommodates natural transitions

between pre-function space and meeting rooms. Views from floor-to-ceiling windows, a skywalk and a beautifully landscaped courtyard rejuvenate delegates.

In the 2,000-square-foot kitchen, industry-leading equipment and a well-designed flow bring conference cuisine to a whole new level ensuring that the fresh West Coast cuisine is served promptly at an optimal temperature.



# High-tech, high-style centre

The Vancouver Island Conference Centre is both a high-tech marvel and an artfully designed beauty. It's a full-service venue and a grand-scale urban gathering place. It's the ideal setting for your next conference.

The service elevator can hold a full-size SUV. The power supply (up to 400 amps) is enough to run a small sawmill. More than 50 floor ports discretely hide electrical, data and phone cords. And that's only the beginning.

The Vancouver Island Conference Centre boasts full wireless access, digital way-finding and outstanding global broadcast capabilities. You also get the most advanced audio, video and control system in Western Canada. It's all seamlessly integrated behind the scenes.

## Flexible meeting spaces

This 38,000-square-foot space is ideal for conferences, tradeshows and events. It easily accommodates up to 1,300 people for theatre-style functions or stand-up receptions.

Natural light streams in through large windows in each of the nine multi-purpose meeting rooms with full audio/visual capabilities. Large groups are easily accommodated with the 13,000 sq.ft. ballroom, the 200-seat tiered Shaw Auditorium, the adjacent 800-seat tiered Port Theatre and the Nanaimo Museum space. Two levels of underground parking mean convenient access for your delegates.



## Green meetings

At every stage of development the centre considered eco-friendly options. You'll see low water flow bathroom fixtures, paperless electronic signage, and low-heat glass that blocks ultraviolet light and helps moderate indoor temperatures.



Visit us online at [www.viconference.com](http://www.viconference.com)

# How to get here

No matter which route you take, you can't miss the spectacular natural beauty of snow-capped peaks, lush rainforests and serene harbours.

From	To	By Ferry	Time	Sailings/Day*
Vancouver	Nanaimo	Horseshoe Bay to Departure Bay	1.5 hrs.	8
Vancouver	Nanaimo	Tsawwassen to Duke Point	2.0 hrs.	8

From	To	By Seaplane 	Time	Flights/Day*
Vancouver	Nanaimo	Vancouver (Downtown) to Nanaimo (Downtown Harbour)	20 min.	16-37
Vancouver	Nanaimo	Vancouver Airport (Richmond) to Nanaimo (Downtown Harbour)	20 min.	11-20
Seattle	Nanaimo	Seattle (Lake Washington) to Nanaimo (Departure Bay)	1.25 hrs.	2 (summer)

From	To	By Commercial Air*	Time	Flights/Day*
Vancouver	Nanaimo	Vancouver International Airport to Nanaimo Airport	20 min.	6-8

 Nanaimo Downtown Harbour within walking distance of Vancouver Island Conference Centre

\* By Commercial Air - Two other Vancouver Island cities, Victoria and Comox Valley, have international airports offering more flights and cities served.

\* Ferry Sailings & Flights - Number of sailings/flights per day and departure times vary, please verify if important.





# Where to stay in Nanaimo



Find the perfect place to relax and unwind in one of the 1,200 well-appointed guestrooms throughout Nanaimo or in 1,000 additional rooms just outside the city.

The Nanaimo area offers accommodation options to suit every taste and budget – from luxurious harbourside resorts to campus-style housing, full-service hotels to motor inns, forested campsites to charming B&Bs. If convenience is top priority, more than 500 guestrooms are located within walking distance of the Vancouver Island Conference Centre.

Check our website at [viconference.com](http://viconference.com) for details on local properties. Or contact us. Our team will assist your group in researching appropriate delegate accommodations.

## Nanaimo in a nutshell

Population  
80,000

Location  
Nanaimo is located on the east side of Vancouver Island, 113 km north of Victoria, and 55 km across the Strait of Georgia from Vancouver.

Climate  
A warm, temperate climate makes Nanaimo an ideal four-season destination. The city's coldest months

(November - February) typically experience daytime highs of 6°C to 9°C and lows of 0°C to 2°C. The summer months (June - September) see average daytime highs in the mid-20s°C and lows of about 10°C.

Main Industries  
Tourism, advanced manufacturing, technology, business and government services, arts and culture, regional retail, health, and education.



Visit us online at [www.viconference.com](http://www.viconference.com)

# Vancouver Island Conference Centre



Experience the Vancouver Island Conference Centre, Canada's newest and most exciting meeting and event venue located in downtown Nanaimo, British Columbia.

## Partners



# Capacities

Conference & Auditorium Level	MODULE 1	Area Sq. Feet	Area Sq. Metres	Dimensions Feet length x width	Theatre	Classroom	Hollow Square	U-Shape	Banquet	Reception	Exhibits 8'x10'
	Mt Benson Ballroom	13,697	1,272	142.5 x 95.5	1,200	640			960	1,340	84
	Ballroom A	2,275	211	47.5 x 47.5	180	88	68	72	140	220	14
	Ballroom B	2,269	210	39.5 x 47	180	88	68	72	140	220	14
	Ballroom A/B	4,544	422	87 x 94.5	380	192			320	440	28
	Ballroom C	4,623	429	48 x 95.5	400	200			320	450	28
	Ballroom D	4,530	420	47 x 95.5	400	192			320	450	28
	Lantzville Room	921	85	38 x 37.5	76	32	30	22	50	80	5
	Millstone River Room	770	71	26.5 x 27.5	65	36	26	20	50	50	4
	Departure Bay Room	1,337	124	53 x 66.5	112	60	48	42	80	100	6
	Departure Bay A	668	62	26 x 28	56	30	24	18	40	50	3
	Departure Bay B	668	62	26 x 28	56	30	24	18	40	50	3
	Duke Point Room	1,004	93	39.5 x 29	76	32	30	22	60	80	3
	Newcastle Island Lobby	7,368	684	53 x 66.5						400	20



Theatre



Classroom



U-Shape



Hollow Square



Banquet



Reception

Shaw Auditorium	MODULE 2	Area Sq. Feet	Area Sq. Metres	Dimensions Feet length x width	Theatre	Classroom	Hollow Square	U-Shape	Banquet	Reception	Exhibits 8'x10'	
	Shaw Auditorium*	2,598	241	Contains tiered seating for 200								
	Nanaimo River Room	1,868	173	44.5 x 40.5	120	84	66	60	120	180	11	
	Nanaimo River A	955	88	23 x 40.5	64	42	34	28	60	90	6	
	Nanaimo River B	913	84	21.5 x 40.5	60	39	32	25	50	88	5	
	Shaw Lobby	3,715	345							200	7	
	Douglas Rispin Room	Permanent Boardroom Set-up for 10 people										

Museum Level	MODULE 2	Area Sq. Feet	Area Sq. Metres	Dimensions Feet length x width	Theatre	Classroom	Hollow Square	U-Shape	Banquet	Reception	Exhibits 8'x10'
	Dodd Narrows Room	2,658	246	42.5 x 61	143	132	80	64	143	143	16
	Dodd Narrows A	1,421	132	42.5 x 33	130	63	44	36	80	135	8
	Dodd Narrows B	1,237	114	42.5 x 28	120	54	40	32	70	125	7
	Piper's Lagoon Lobby	1,686	156							143	4

Port Theatre*	Contains tiered seating for 800										
---------------	---------------------------------	--	--	--	--	--	--	--	--	--	--

\* Tiered / Fixed Seating

Maximum room capacities are listed. Room set-up requirements may reduce capacities.

Classroom capacities based on 8' x 18" tables – seating 4 persons per table.

Maximum Banquet capacities are based on 66" round tables seating 10 persons per table – no allowance for head table, buffet tables or dance floor.

# Floor plans



Tel 250.244.4050  
 Fax 250.244.4055  
 Toll Free 866.430.6338  
[www.viconference.com](http://www.viconference.com)

101 Gordon Street  
 Nanaimo, British Columbia  
 Canada V9R 5J8

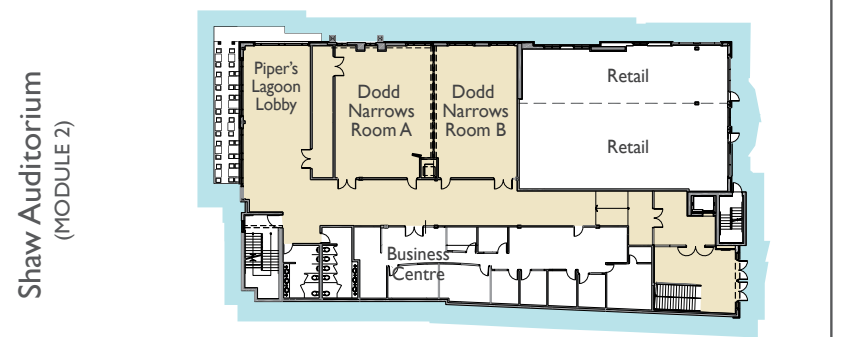
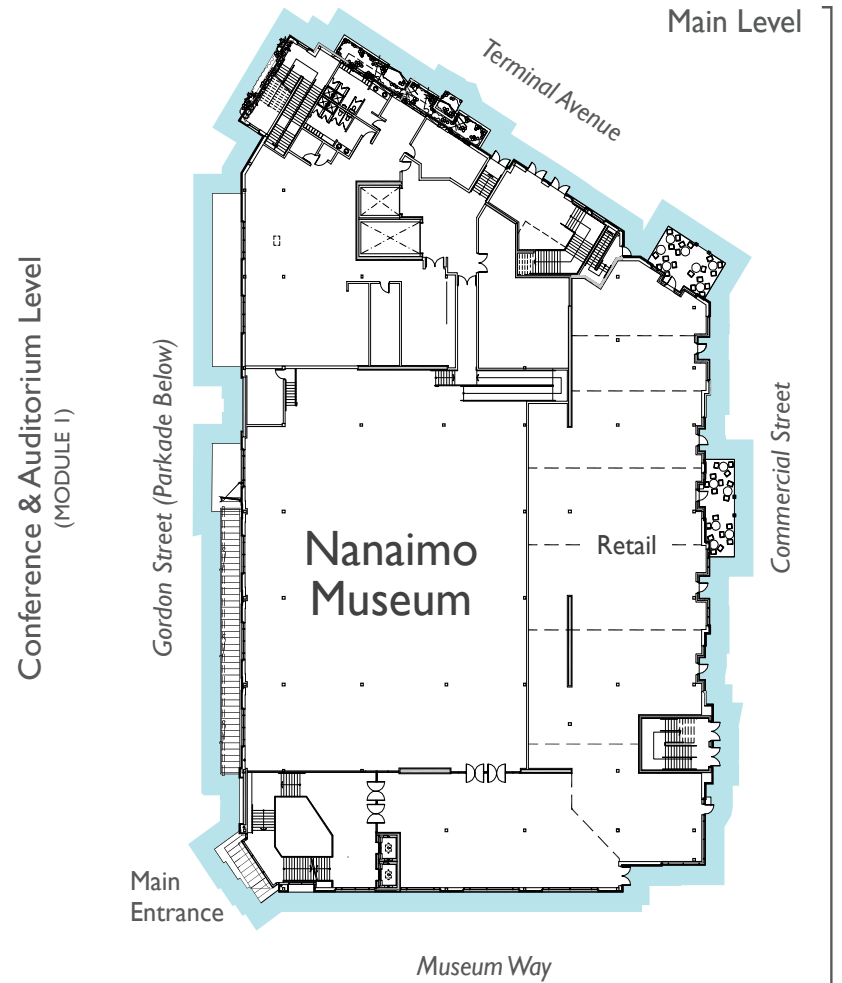
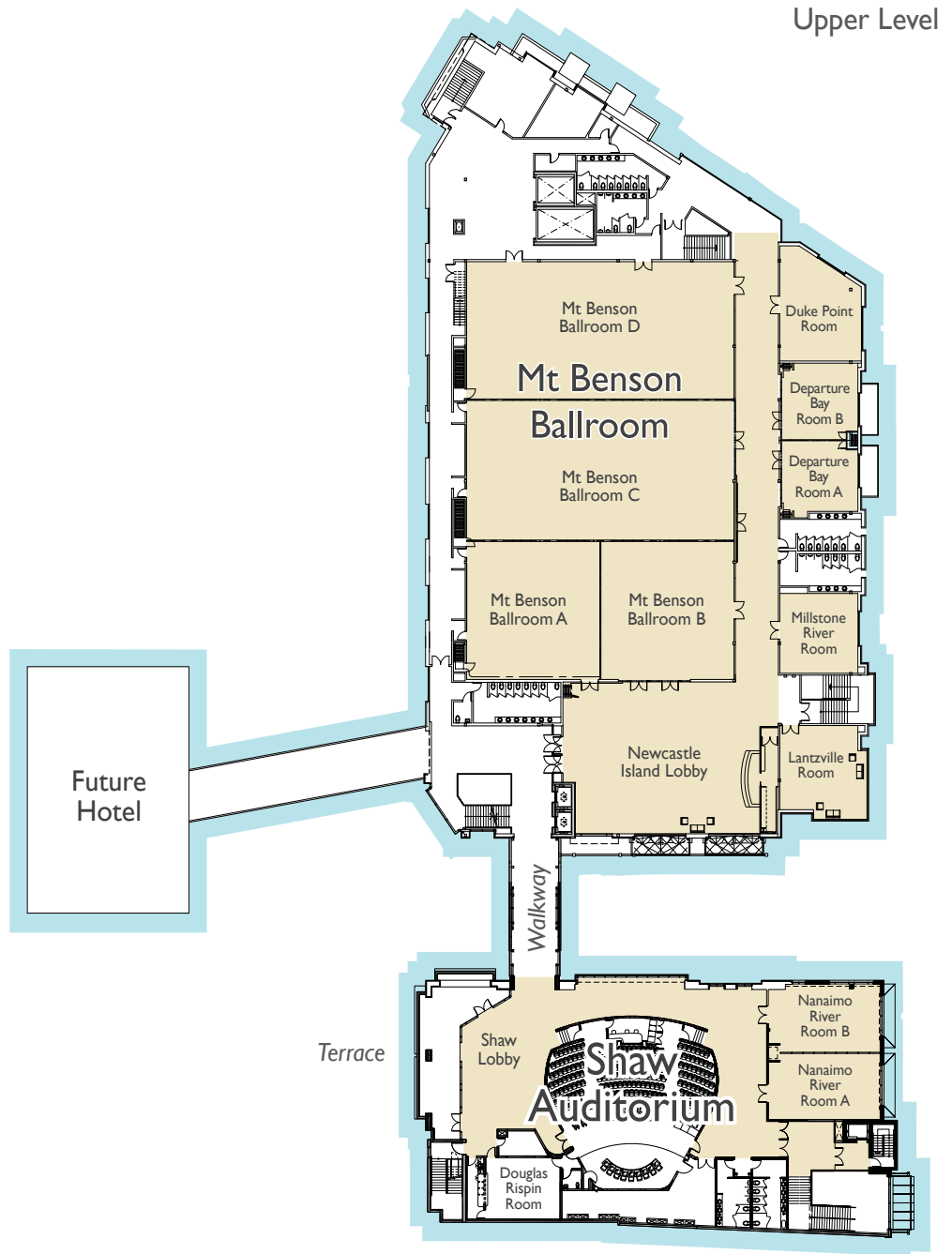

Museum Level (MODULE 3)



**VANCOUVER ISLAND  
CONFERENCE CENTRE**

**Tel** 250.244.4050  
**Fax** 250.244.4055  
**Toll Free** 866.430.6338  
**www.viconference.com**

101 Gordon Street  
Nanaimo, British Columbia  
Canada V9R 5J8

**This planner is printed on Save-A-Tree® paper.**  
Save-A-Tree® is manufactured from 100% post-consumer fiber.  
No new trees are used in the manufacturing of this product.  
To review the eco-audit, please visit [www.viconference.com](http://www.viconference.com)